

lusk

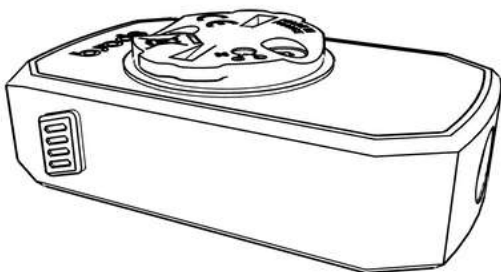

Beacon 150 C

User Manual

Introduction

The Beacon 150 C is a compact front daytime running light that enhances rider visibility in daylight and low-light conditions.

This manual provides all the information needed to install and use your device. Please read it carefully before first use.

⚠ WARNING

Check local lighting regulations before use. Flashing light and maximum brightness may not be allowed everywhere. This light is not compliant with German StVZO regulations.

Included Parts



Beacon 150 C



Quarter Turn Mount



2x M3x6



2x M3x8



2x M3x10



Torx Key T10

Beacon 150 C Overview

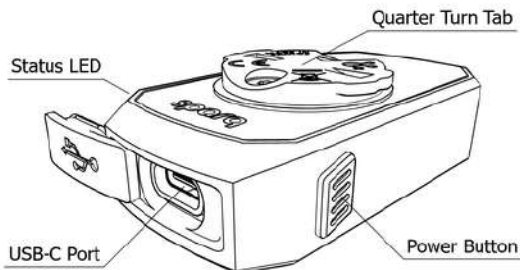

Mounting the Beacon 150 C

INFORMATION

The Beacon 150 C may not be compatible with all bike computer mounts. Visit luskssports.com/product/beacon-150-c/#compatibility for compatibility details.

The Beacon 150 C is designed to be mounted under a bike computer mount.

STEP 1:

If your bike computer mount **DOES** have threaded holes, follow **OPTION A**.

If your bike computer mount **DOES NOT** have threaded holes, follow **OPTION B**.

OPTION A

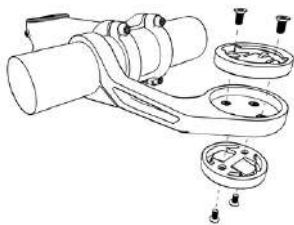

OR

OPTION B

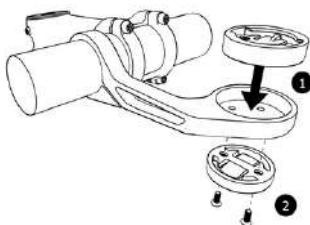

NOTE: Adjust the orientation of the quarter-turn mounts so that your bike computer points forward when mounted.

Use the longest screws (6, 8, or 10 mm) that fit without sticking out.

STEP 2 (Optional):

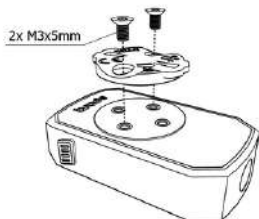

STEP 3:

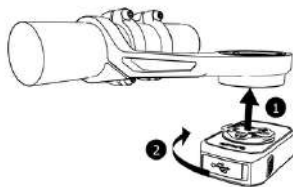

NOTE: Adjust the orientation of the quarter-turn tab so that the Beacon 150 C points forward when mounted.

STEP 4:



Power On / Power Off

Hold the power button for 1 second to turn the device on. When powered on, the Beacon 150 C returns to the last active mode.

Hold the power button for 2 seconds to turn the device off.

Lighting Modes

Press the power button briefly to cycle through the lighting modes.

| Mode | Luminous Flux (lumens) | Runtime (h:min) | Use case |
|-------------|------------------------|-----------------|--|
| High | 150 | 2:20 | Low-visibility conditions (fog, rain, bright daylight) |
| Medium | 100 | 3:50 | General use |
| Low | 50 | 7:20 | Night riding or low-light environments |
| Day flash | 100 (max.) | 17:30 | High-visibility flash for daytime riding |
| Night Flash | 50 (max.) | 20:00 | Always-on flash for nighttime riding |
| Standby | 0 | Up to 5 month | Light off; awaits control from a bike computer |

Battery Indicator

When the device is on, the status LED periodically indicates the battery level.
When the device is off, press the power button briefly to view the battery level.

| Status LED | Battery level |
|-----------------|---------------|
| Blinking green | 66 - 100 % |
| Blinking yellow | 33 - 65 % |
| Blinking red | 0 - 32 % |

Charging the Beacon 150 C

WARNING

Charge the device only within the temperature range of 10 °C to 45 °C (50 °F to 113 °F) and in a dry environment.

Ensure the USB-C port cover is closed before riding in wet or humid conditions.
If the USB-C port cover is not properly closed, the device may be damaged.

The device uses a battery that you can recharge through the USB-C port.

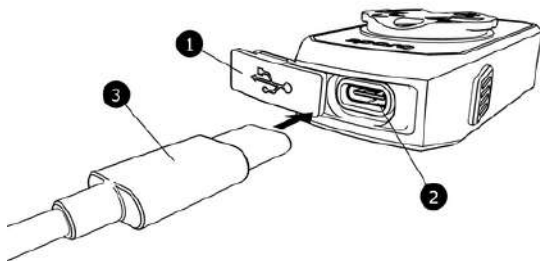

1. Remove the USB-C port cover (1) from the USB-C port (2).
2. Plug a USB-C cable (3) into the USB-C port on the device.
3. Plug the other end of the cable into a computer USB port or a wall adapter (use a certified USB charger rated for at least 500 mA).
4. When the charge is complete, disconnect the USB-C cable and close the USB-C port cover.

NOTE: A full charge takes about 1 h 40 min.

While the device is charging, the status LED indicates the current charge status.

| Status LED | Charge status |
|----------------|--|
| Blinking green | Charging |
| Solid green | Fully charged |
| Solid red | Charge error – Try a different cable or power source |

Pairing the Beacon 150 C with a Bike Computer

You can pair your Beacon 150 C with a compatible bike computer using ANT+ connectivity. This lets you control lighting modes remotely, use automatic functions, and monitor battery level in real time.

NOTE: Refer to your bike computer's user manual to check compatibility. It must support the ANT+ Bike Lights profile.

1. Bring the Beacon 150 C close to your bike computer.
2. Turn on both the Beacon 150 C and your bike computer.
3. On your bike computer, go to the sensors page, select **"Add sensor,"** then **"Search all."** From the search results, select **"Light"** to pair the devices.

NOTE: The pairing procedure may vary slightly depending on your bike computer. If you encounter any difficulties, please refer to your bike computer's user manual for detailed instructions.

Resetting the Beacon 150 C

You can reset the device if it stops responding.

Hold the power button for 10 seconds until the status LED turns red, then blue.

Battery Care

WARNING

Do not attempt to disassemble the device or replace the battery yourself.

Do not operate the device outside the temperature range of -20 °C to 60 °C.

Do not use the device if the battery shows signs of potential damage.

Proper care of the battery ensures long life and optimal performance.

Follow these recommendations for maintaining your battery:

- Avoid fully discharging the battery before recharging; frequent partial charges are preferable.
- Store the Beacon 150 C at room temperature in a dry place.
- If storing the device for an extended period, charge it to approximately 50 %. Check the battery every 6 months and recharge if necessary. Avoid storing it fully charged or fully depleted.

NOTE: Battery performance will naturally decrease over time. Cold temperatures may also temporarily reduce battery capacity.

Beacon 150 C Specifications

| | |
|------------------------------|---|
| Dimensions | 62 x 35 x 16 mm (2.44 x 1.38 x 0.63 in) |
| Weight | 38 g (1.34 oz) |
| Max luminous flux | 150 lm |
| Battery type | Rechargeable Li-Ion Polymer 700 mAh |
| Charging time | 1 h 40 min |
| Charging temperature | 10 °C to 45 °C (50 °F to 113 °F) |
| Operating temperature | -20 °C to 60 °C (-4 °F to 140 °F) |
| Water rating | IPX7 |
| Connectivity | ANT+ |
| Compliance | XX |

Warranty

This product is covered by a 2-year limited warranty from the date of purchase. The warranty covers any defects in materials or workmanship. Within this period, Lusk will, at its discretion, repair or replace any components that fail under normal use.

The warranty does not apply to normal wear and tear, consumable parts such as batteries, damage caused by improper installation, accidents, misuse, abuse, or neglect, damage resulting from unauthorized disassembly, or damage caused by the use of non-certified cables and/or AC adapters.

To make a warranty claim, contact Lusk with proof of purchase. Lusk may require the return of any product submitted for warranty consideration.

For More Information

If you need help not offered by this manual, please contact Lusk at contact@luskports.com or visit luskports.com/contact.